

# USS MISSOURI BATTLESHIP MK.7 16"/50 GUN TURRET No.1

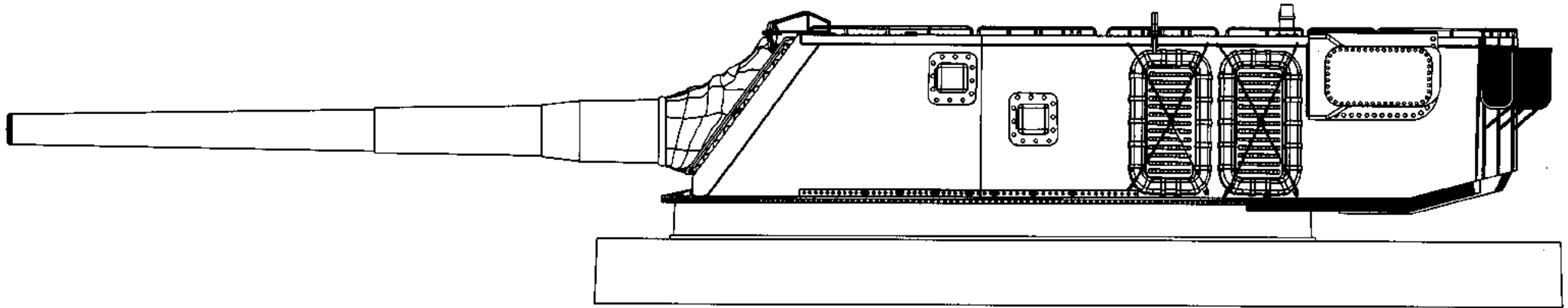

The 16"/50 caliber Mk.7 was the main armament of the USN Iowa-class battleships. These guns were 66.7 ft (20.3 m) long, from chamber to muzzle, with three guns mounted in each of the ship's four main turrets. Each gun weighed about 267,900 lbs. (121,500 kg) and could fire projectiles weighing from 1,900 to 2,700 lbs. (860 to 1,220 kg) at a maximum speed of 2,690 feet per second (820 m/s) with a range of up to 24 mi (39 km). At the maximum range, the projectile spent almost 90 seconds in flight. Each barrel could be elevated and fired independently, and each turret was operated by a crew of 79 men.

The ships could fire any combination of their guns, including a broadside of all nine. The turret interiors were subdivided and designed to permit the independent loading, elevation and firing of each gun. The guns could be elevated from  $-5$  degrees to  $+45$  degrees, moving at up to 12 degrees per second. The turrets could rotate about 300 degrees at about 4 degrees per second and could even be fired back beyond the beam, which is sometimes called "over the shoulder". A red stripe on the wall of each turret, just inches from the railing, marked the limit of the gun's recoil as a safety warning to the turret's crew.

# READ BEFORE ASSEMBLY

## CAUTION

- Read carefully and fully understand the instructions before commencing assembly. A supervising adult should also read the instructions if a child assembles the model.
- When assembling this kit, tools including knives used. Extra care should be taken to avoid personal injury.
- Keep out of reach of small children. Children must not be allowed to suck any part, or pull vinyl bag over their heads.



Be Careful



Instant Glue  
for Metal



Optional

## PAINTS REQUIRED

Color info and profiles by Mig Jimenez

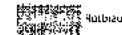

Reddish Brown



New Wood



Grey Thine

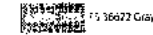

1:13622 Gray



Night Blue Grey

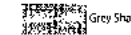

Grey Shadow



Medium Gray

## APPLYING DECALS

1. Clean the model surface with a wet cloth.
2. Cut out each decal design from sheet, and dip it in tepid water for 15~20 sec.
3. Hold the backing sheet edge and slide decal onto the model.
4. Move decal into position by wetting decal with finger.
5. Press decal gently down with a soft cloth until excess water and air bubbles are gone.

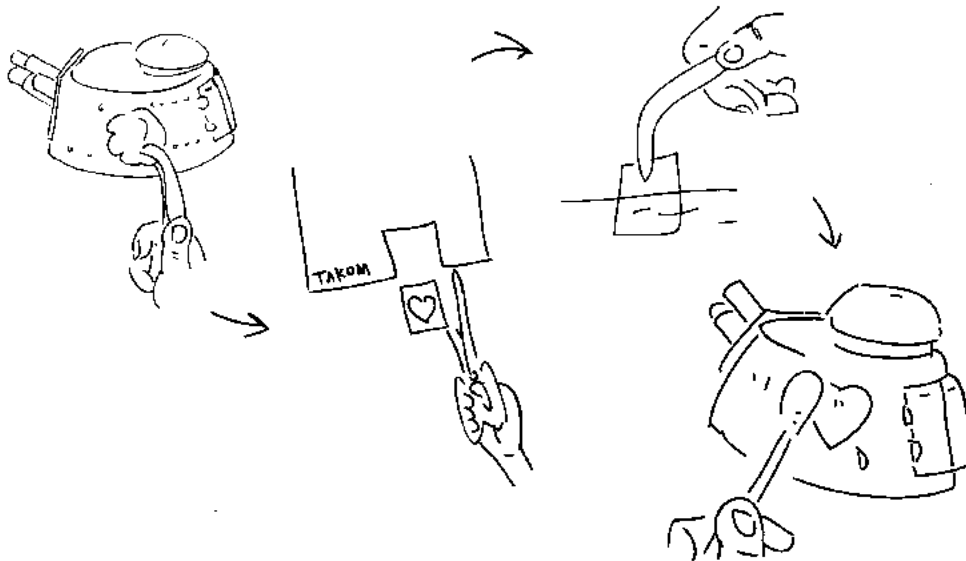

## REMOVING PE

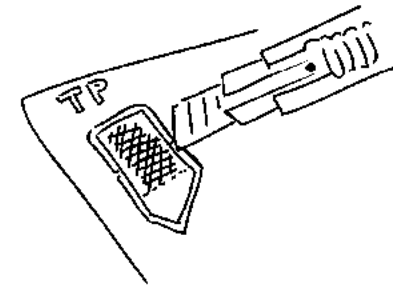

Be careful not to hurt when removing PE parts.

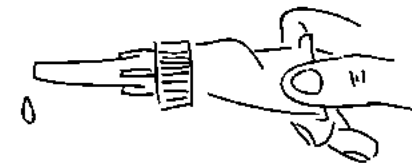

Secure using instant glue (not included).

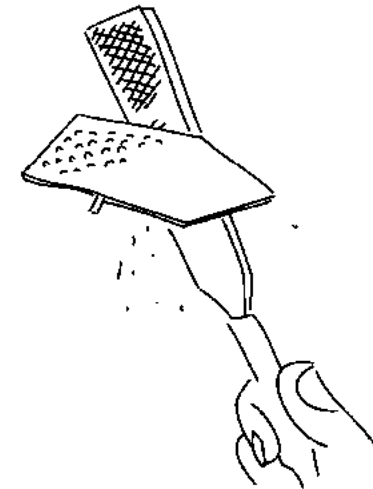

Finish using file.

# PARTS

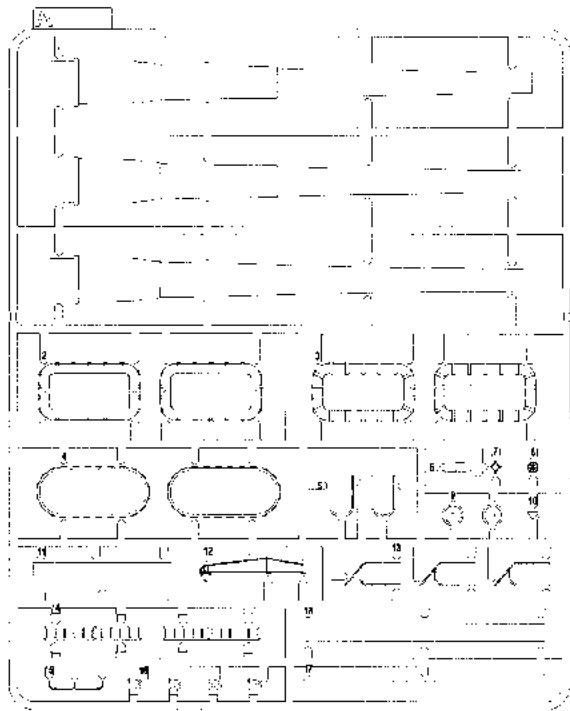

X2

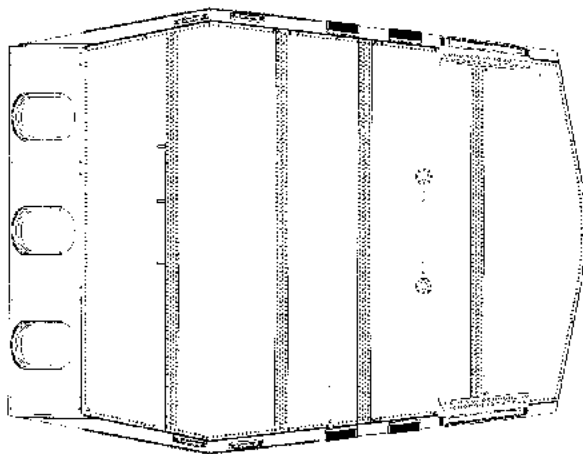
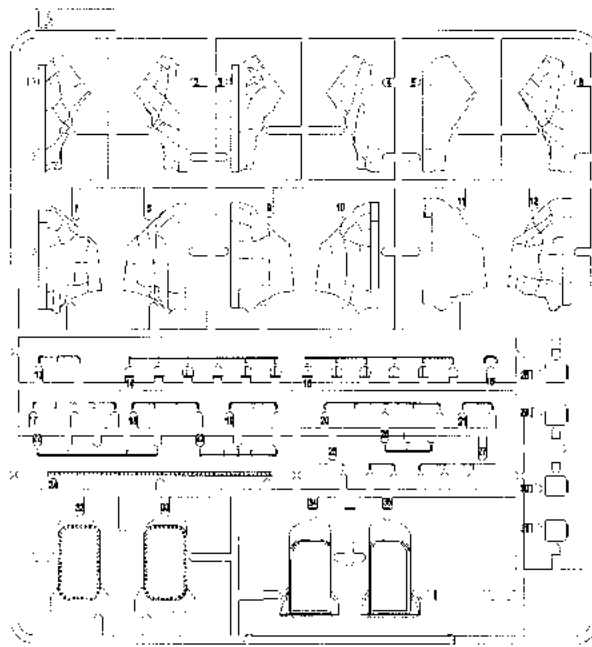

C

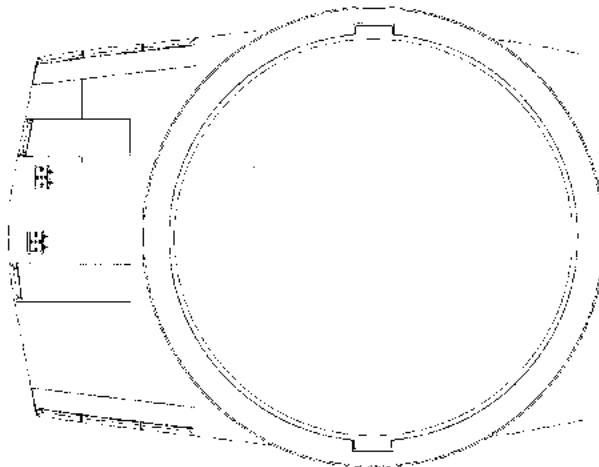

D

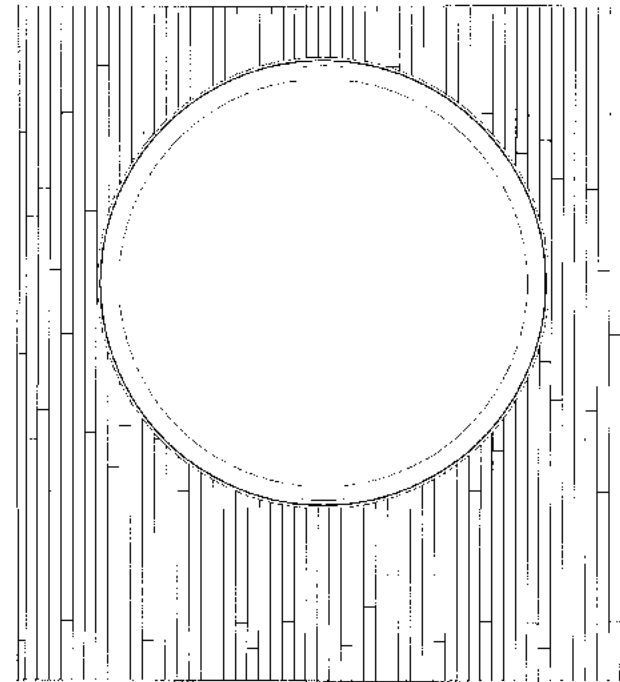

E

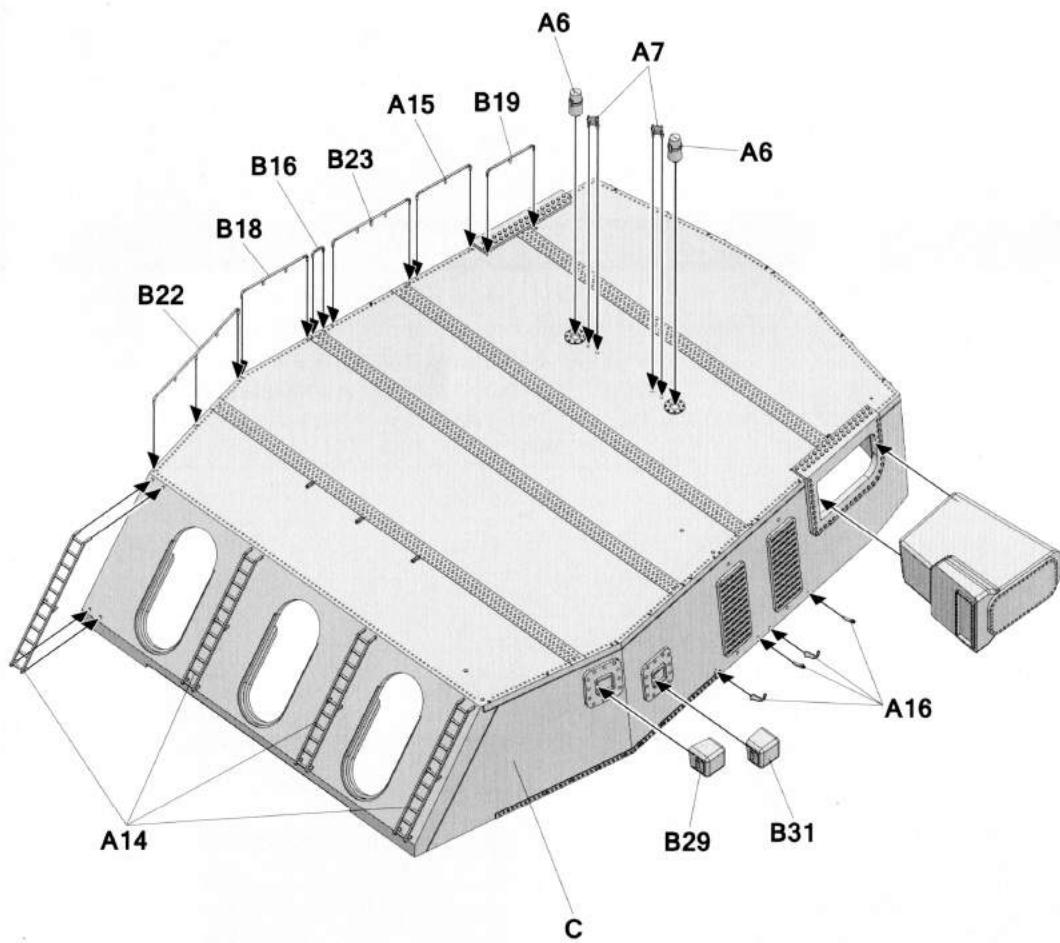
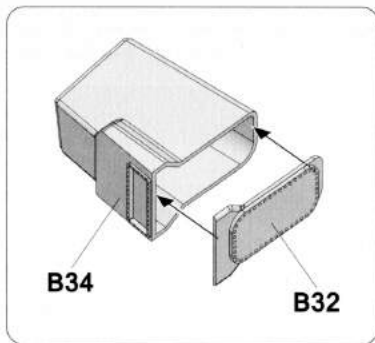
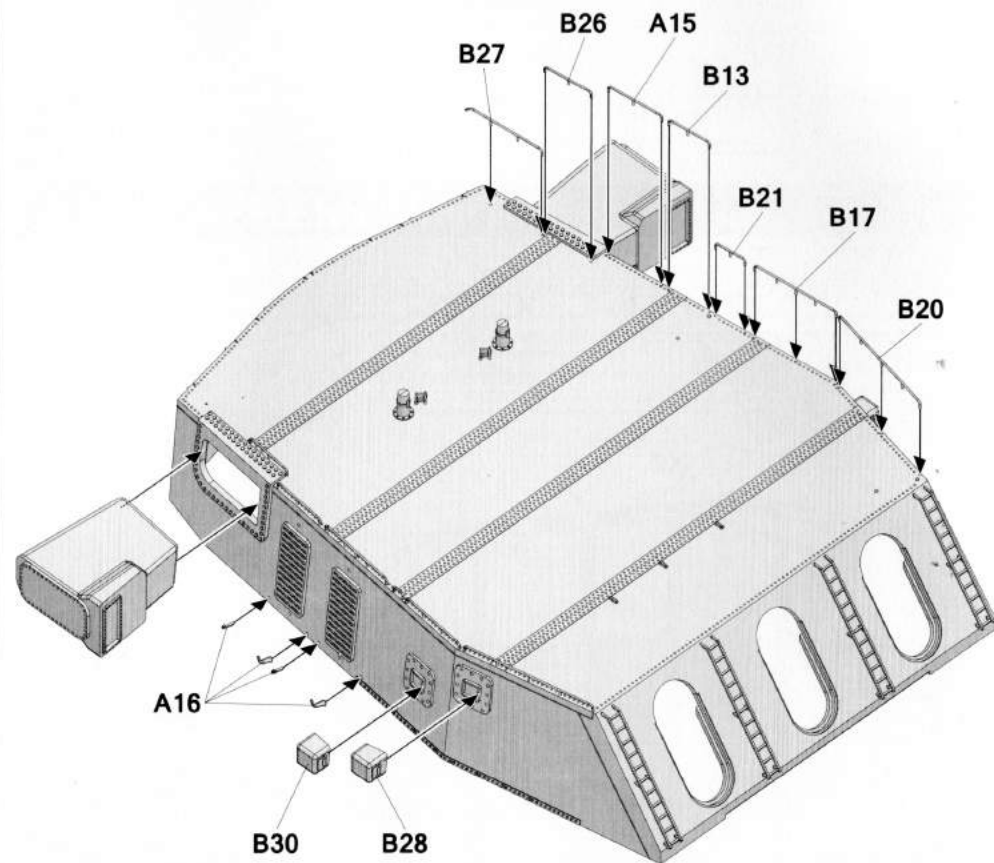
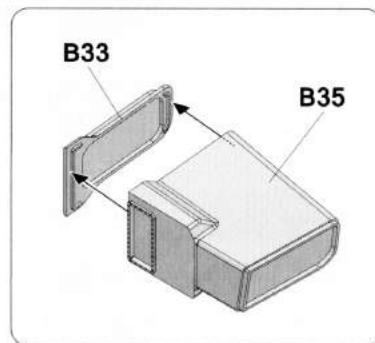

TP

**1****2****3**

3

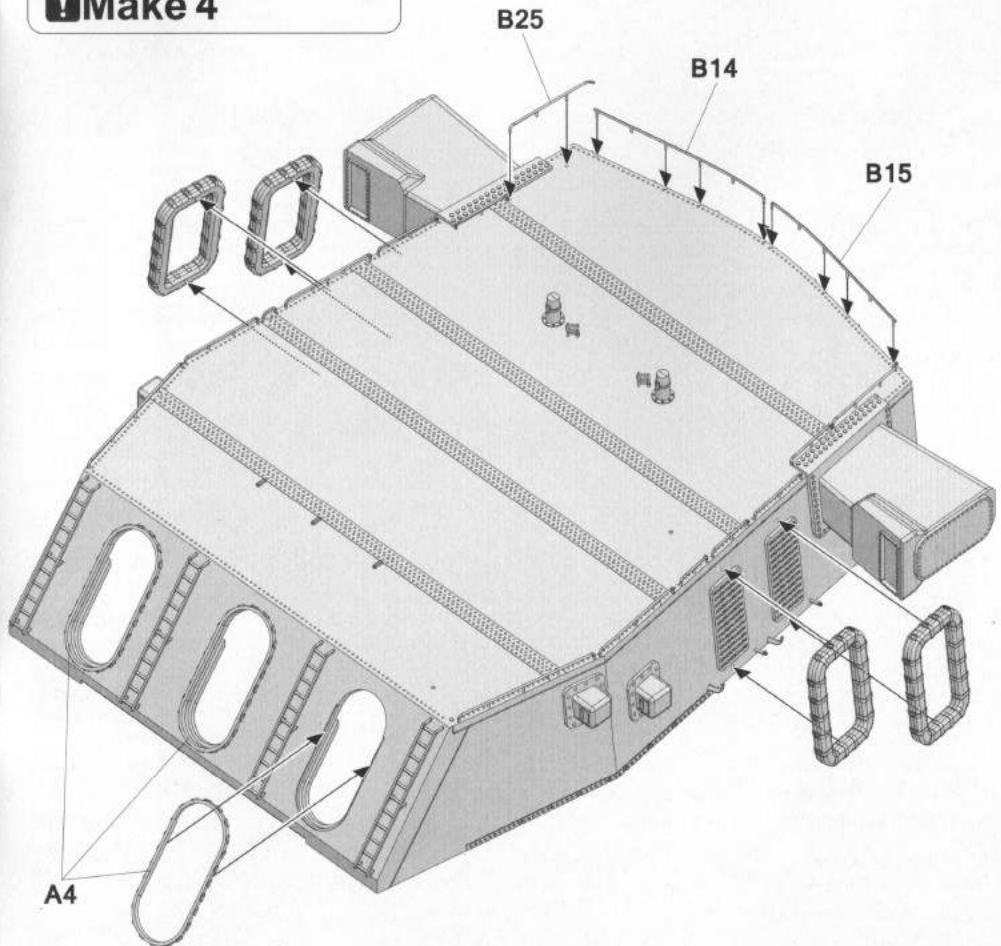
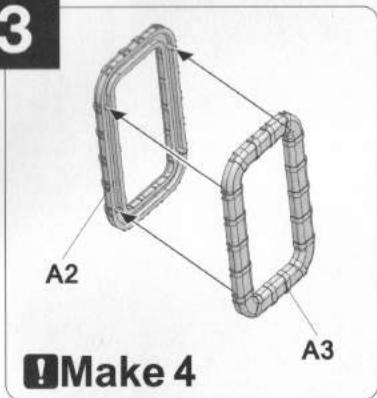

4

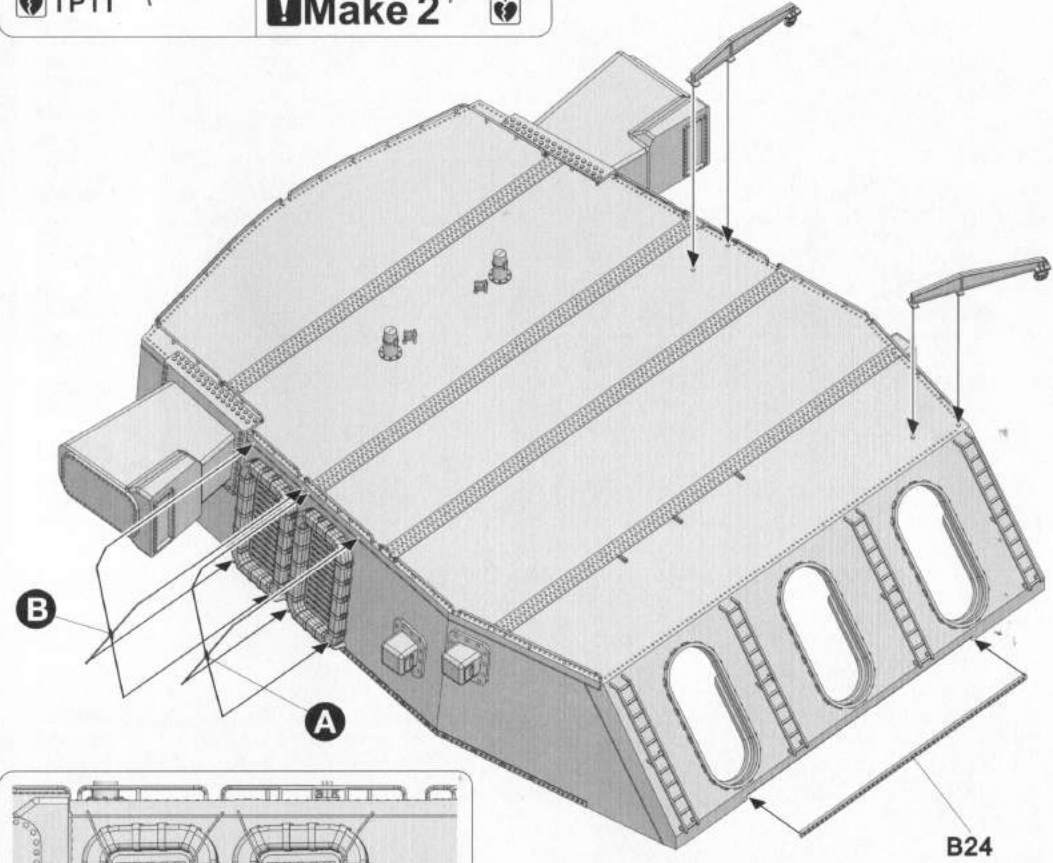
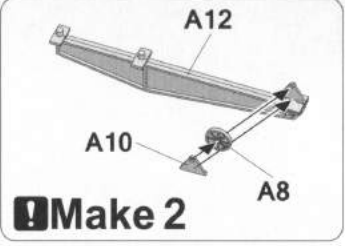
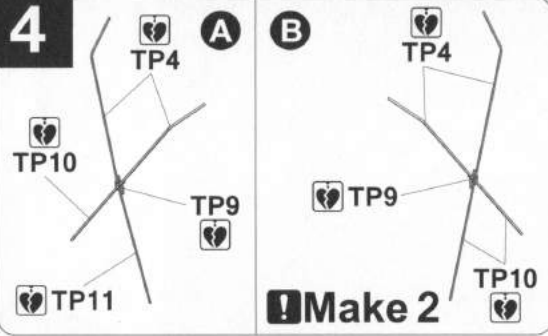

5

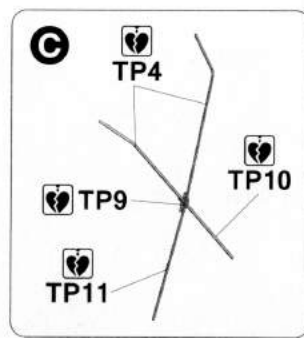
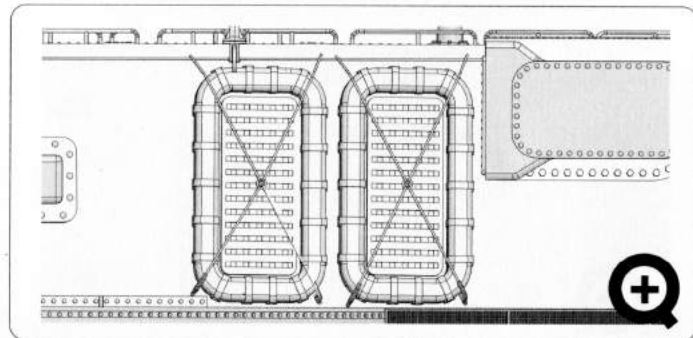
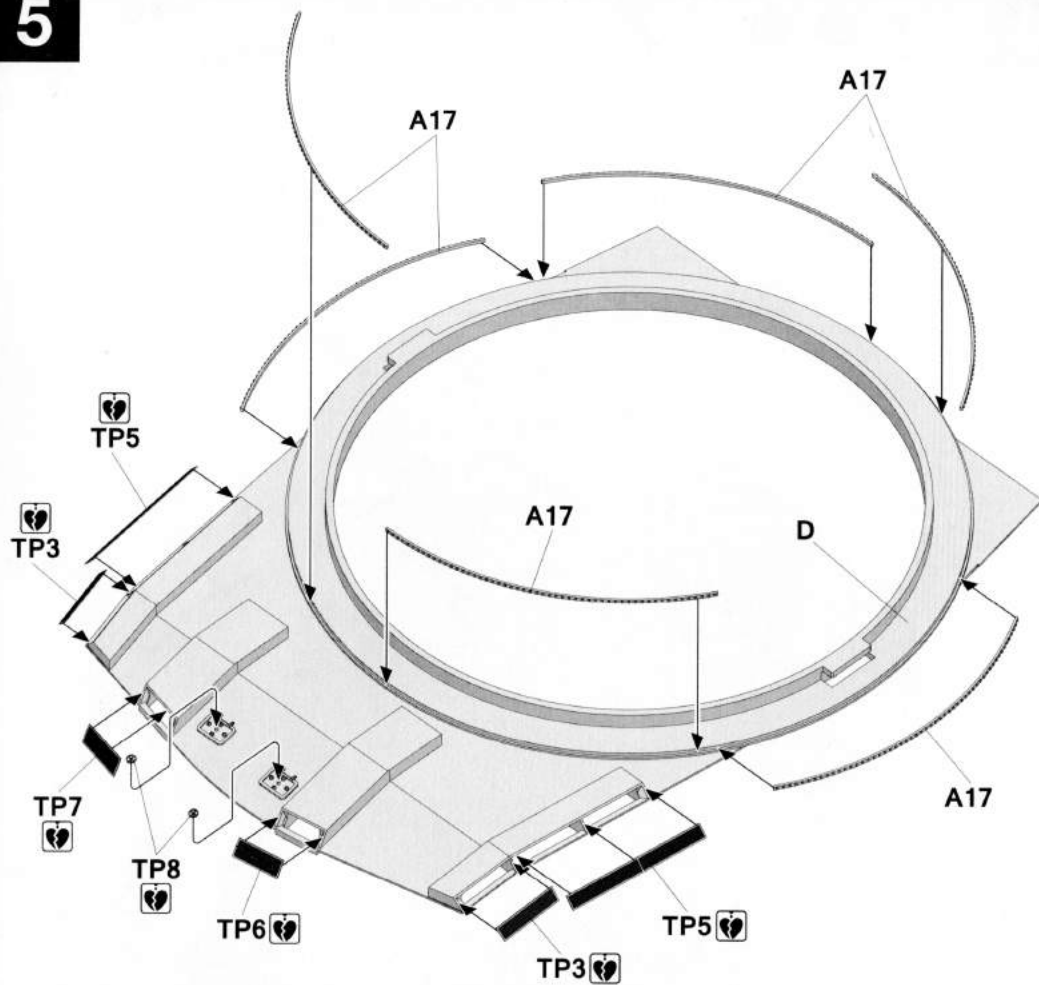

6

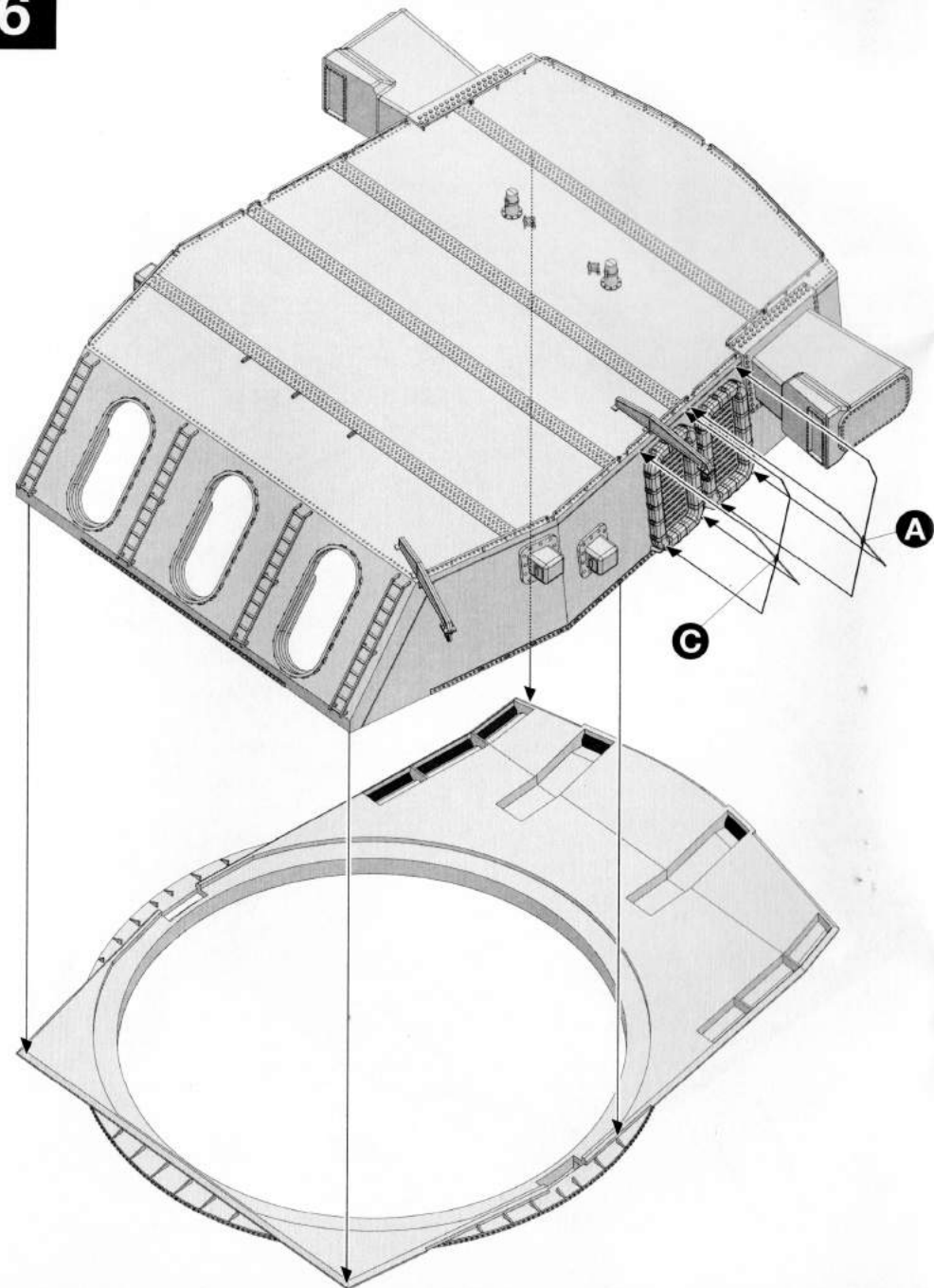

7

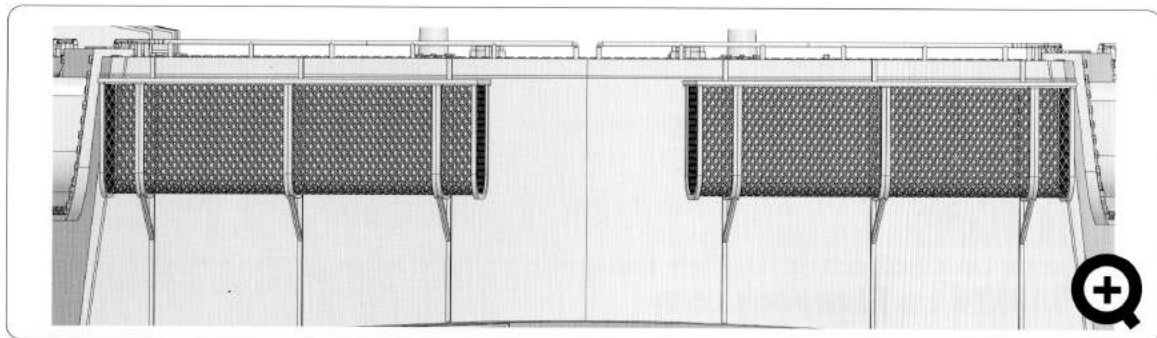
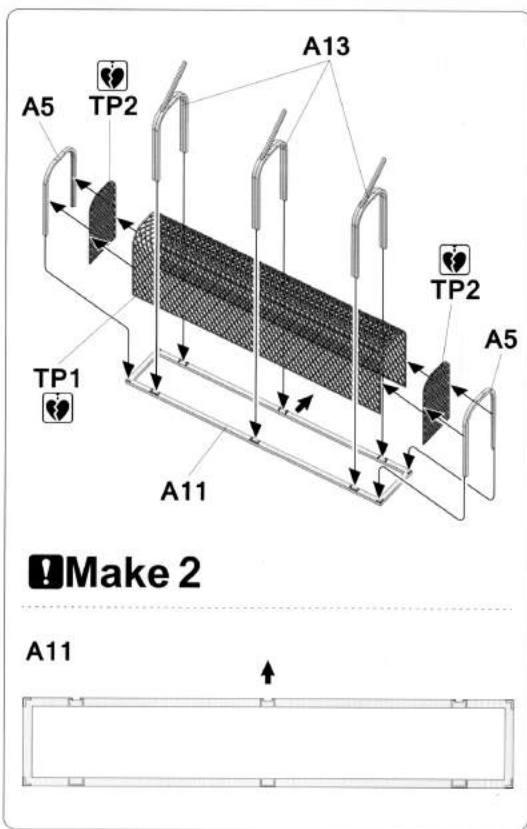
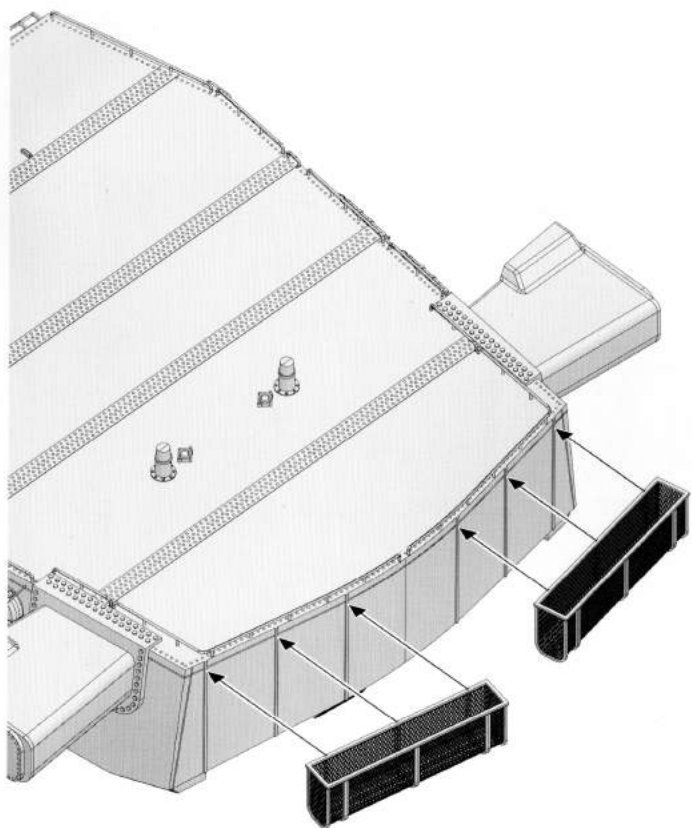

6

8

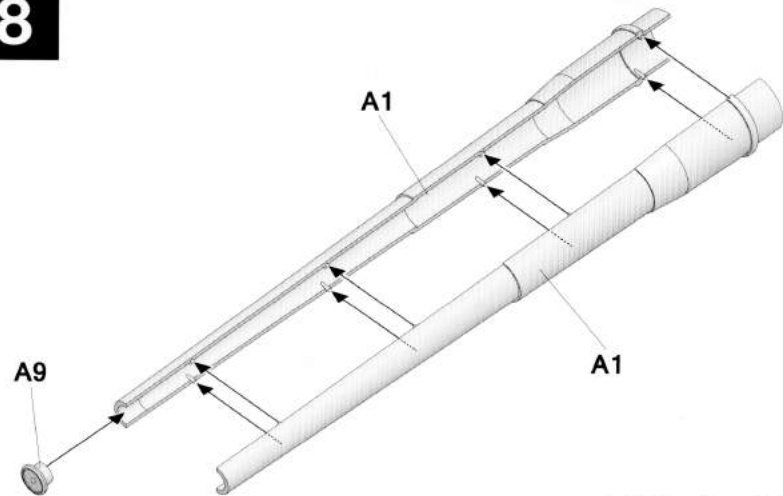

**Make 3**

**D**

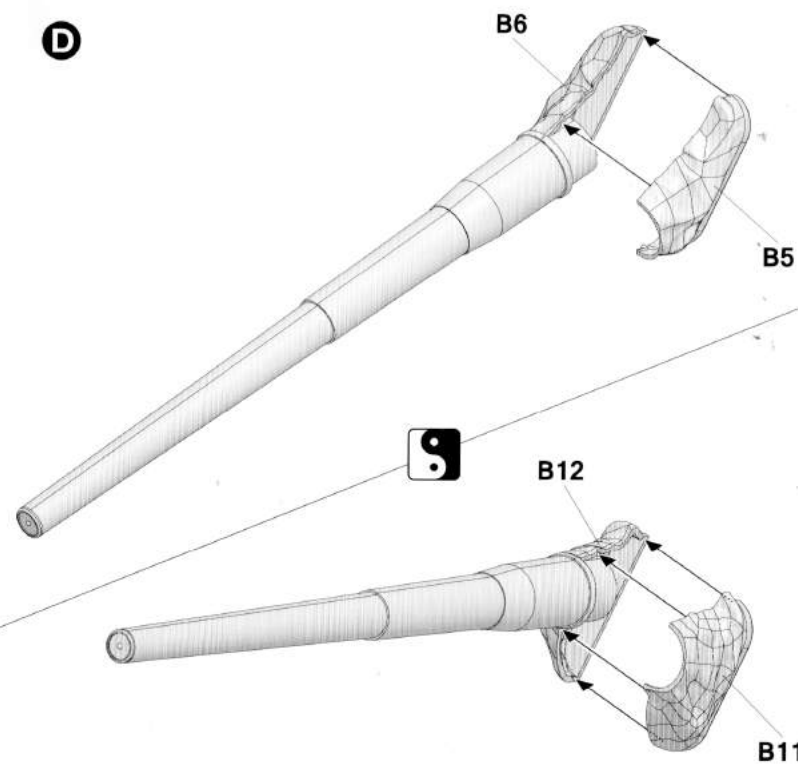

B11

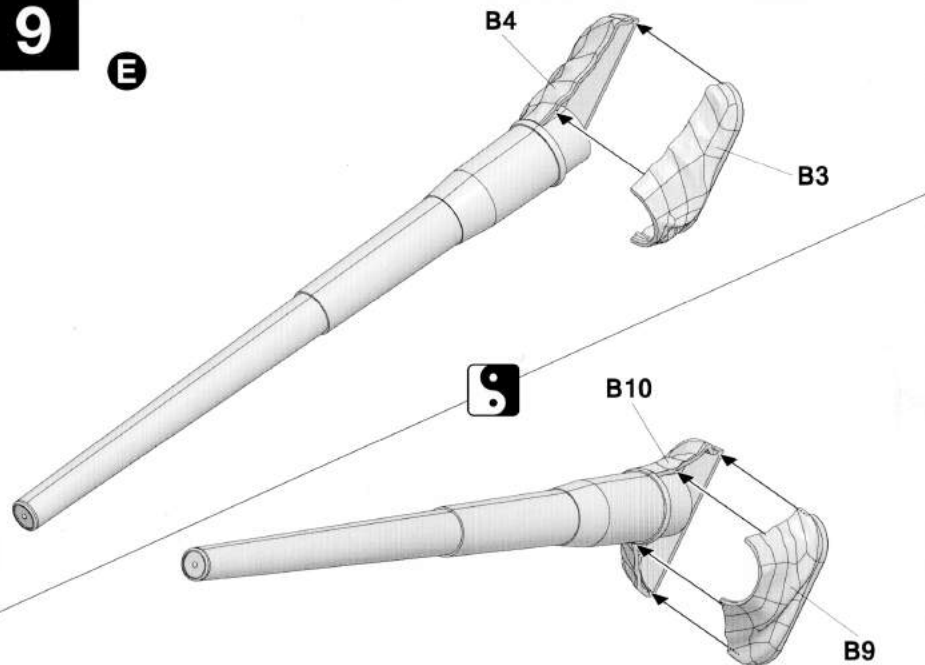
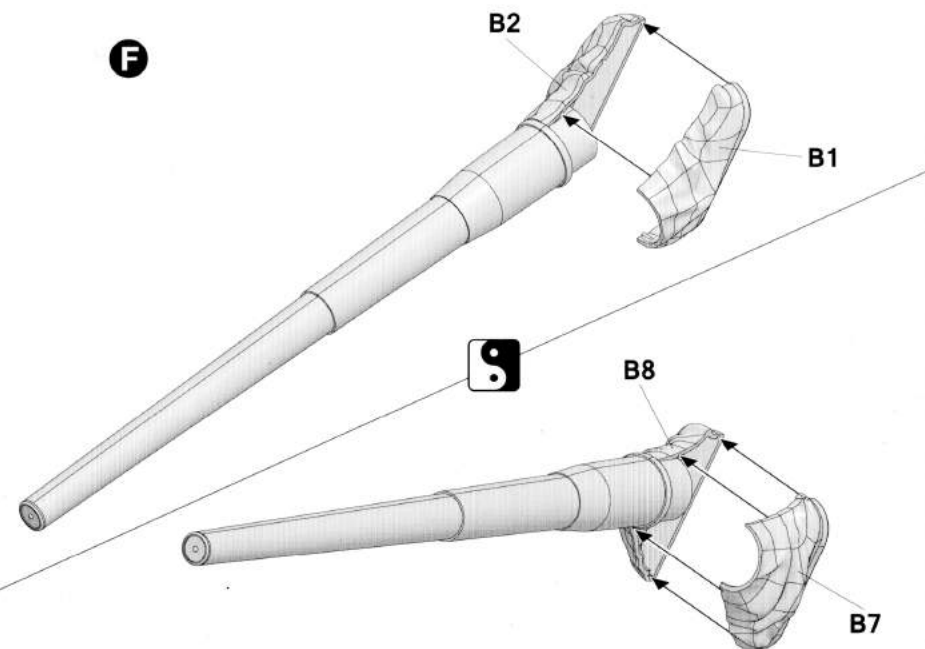
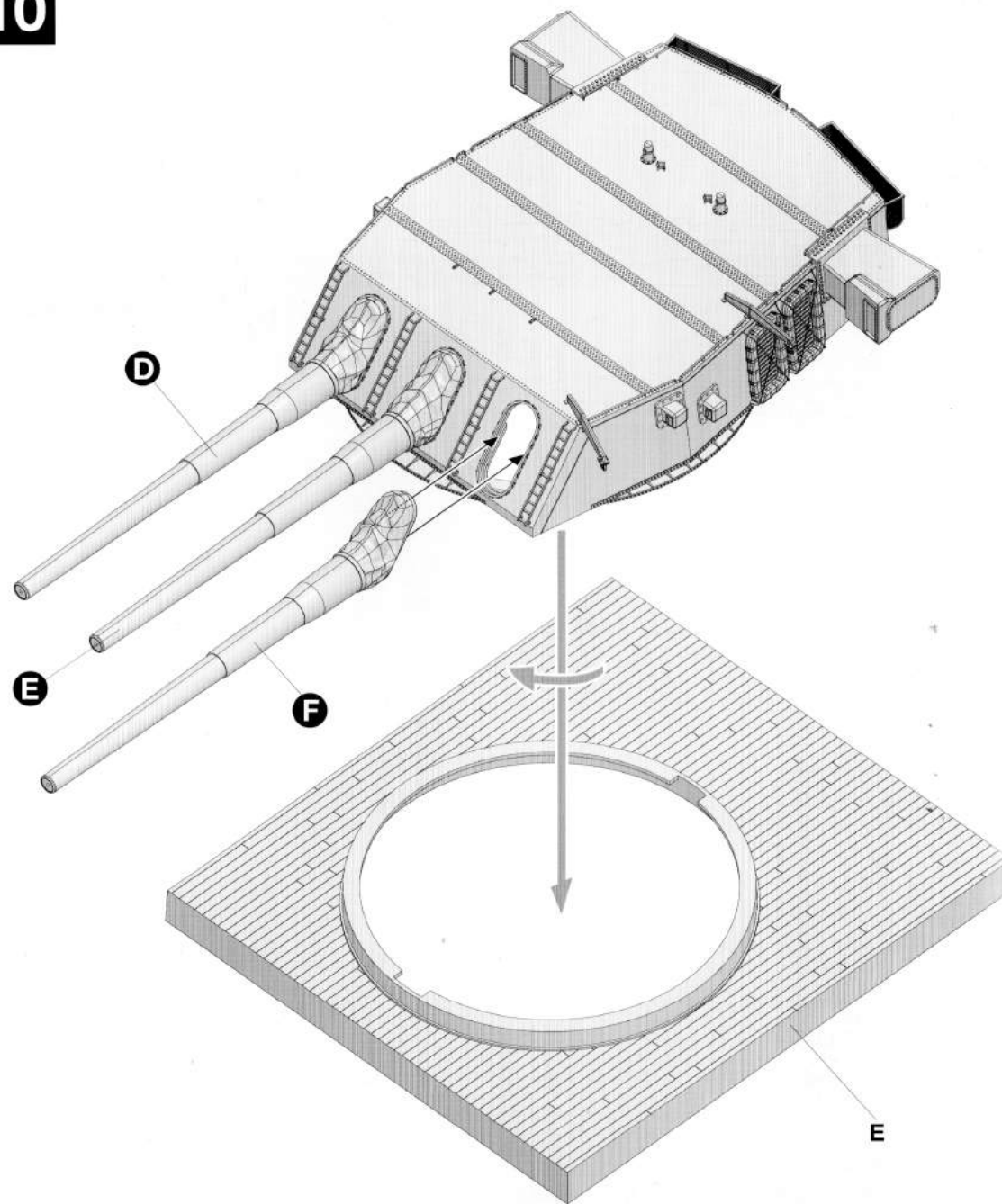

**9****E****F****10**



03.03.5015



# USS MISSOURI BATTLESHIP

## MK.7 16"/50 GUN TURRET No.1



by MIG Jimenez

www.ammo.es

Painting and Marking Guide

A.MIG-0014

Rotbraun

A.MIG-0037

New Wood

A.MIG-0192

Grey Shave

A.MIG-0226

FS 30522 Grey

A.MIG-0250

Night Blue Grey

A.MIG-0906

Grey Shadow

TAKOM No.5015

MK.7 16"/50 GUN TURRET No.1

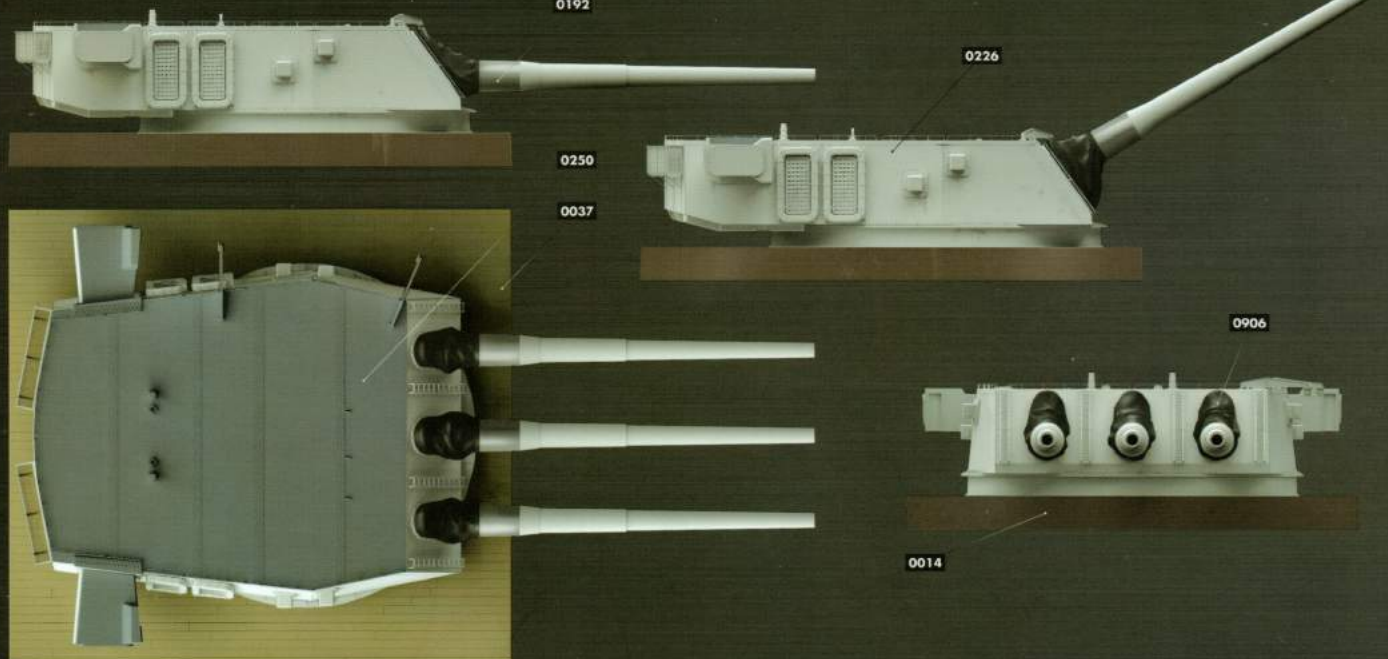

WEATHERING STEPS WITH AMMO PRODUCTS

1 FILTER

A.MIG-1501 Grey for White

2 GENERAL WASH

A.MIG-1008 Dark Wash

3 DIRT SHADING

A.MIG-0853 Dirt Shader

4 DETAILS HIGHLIGHT

A.MIG-3809 Medium Grey

5 STREAKING

A.MIG-1254 Rust

6 DUST

A.MIG-3028 City Dark Dust

7 OIL

A.MIG-1408 Fresh Engine Oil

03.03.5015



# USS MISSOURI BATTLESHIP

## MK.7 16"/50 GUN TURRET No.1



by MIG Jimenez

www.ammo.es

Painting and Marking Guide

A.MIG-0014

Rotbraun

A.MIG-0192

Grey Shave

A.MIG-0211

Medium Grey

A.MIG-0226

FS 30522 Grey

A.MIG-0250

Night Blue Grey

A.MIG-0906

Grey Shadow

TAKOM No.5015

MK.7 16"/50 GUN TURRET No.1

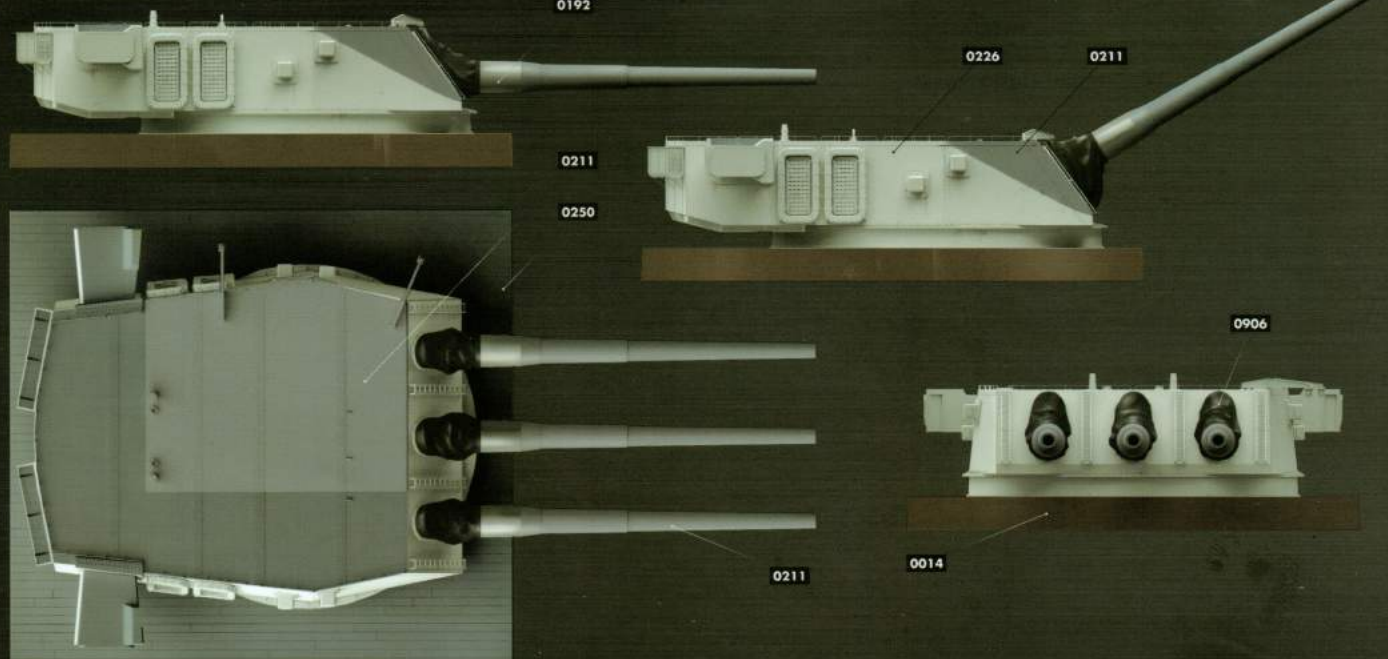

WEATHERING STEPS WITH AMMO PRODUCTS

1 FILTER

A.MIG-1501 Grey for White

2 GENERAL WASH

A.MIG-1008 Dark Wash

3 DIRT SHADING

A.MIG-0853 Dirt Shader

4 DETAILS HIGHLIGHT

A.MIG-3809 Medium Grey

5 STREAKING

A.MIG-1254 Rust

6 DUST

A.MIG-3028 City Dark Dust

7 OIL

A.MIG-1408 Fresh Engine Oil